

Application for Zoning Permit – Applicant MUST be Legal Property Owner!

Name: _____

Telephone: _____ Date of Application: _____

Email (option): _____

Owner's Mailing Address: _____

Job Site Address: _____

Legal Description: Lot _____ Block _____ Addition: _____

or Tax Parcel Number: _____ Is this a corner lot? Y N

Contractor: _____

License #: _____ Contractor Telephone Number: _____

Project Description: _____

Proposed Use: Residential Commercial

If doing Construction:

Front or Width in feet: _____ Side or Length in feet: _____

Height in feet: _____ Number of Stories: _____

Type of foundation: _____

Total Cost of Project (including materials & labor): _____

**NO CONSTRUCTION SHALL BEGIN UNTIL THIS APPLICATION HAS BEEN APPROVED BY THE CODE
ADMINSTRATOR OR BUILDING OFFICIAL OF THE CITY OF LAKE PARK!**

**Work must be completed within 1 year of application approval. If work is not completed, a
new zoning permit will be needed.**

CONTINUED ON OPPOSITE SIDE!



Application for Zoning Permit – Applicant MUST be Legal Property Owner!

SITE PLAN DESIGN

Sketch the proposed project on the graph below. Include the following items:

- Lot Size (dimensions)
- Dimensions of the Proposed Project
- Distance from property line (setbacks) on ALL sides.

A large grid for sketching the site plan design. The grid consists of 20 columns and 20 rows of squares, providing a space for drawing the lot, project dimensions, and setbacks.

I hereby certify that the facts stated in this application are true and correct to the best of my knowledge:

Approved

Denied

Signature of Applicant

Date: _____

City Official

Date: _____

SAMPLE Site Plan Design Sketch

(As required on application)

The City of Lake Park requires the front setback to be inspected by city staff prior to installation of footings.

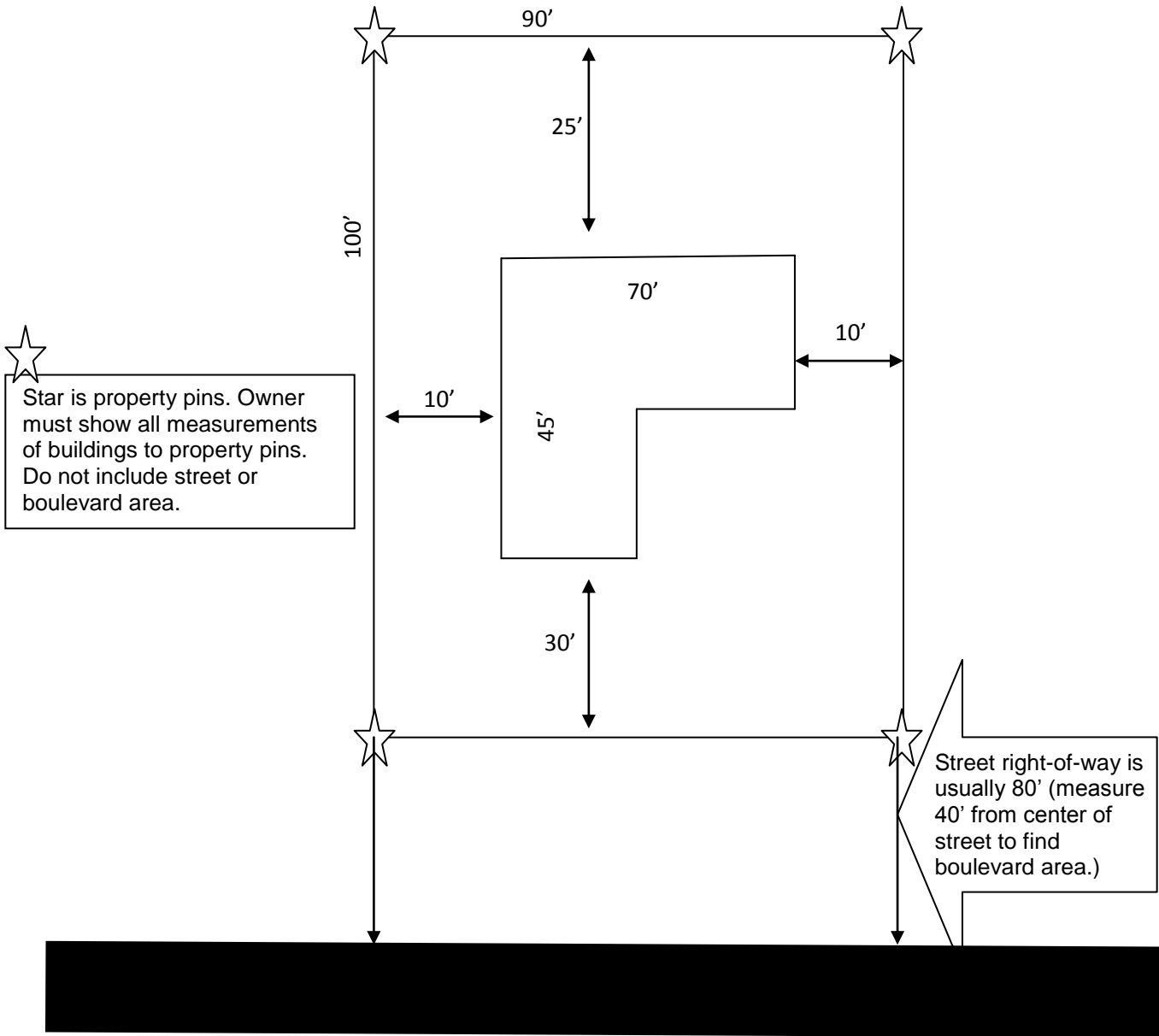

The property owner must contact the City Clerk's office once the structure has been staked out. City staff will measure to ensure that setbacks are adequate. THE CITY OF LAKE PARK ASSUMES NO RESPONSIBILITY OR LIABILITY FOR THE ACCURACY OF ANY PROPERTY PINS.